



### Piano magnetico permanente a poli fitti

Piano magnetico permanente a poli fitti, forza di ancoraggio magnetico efficace anche su pezzi di piccolo spessore.

**Caratteristiche:**

- polo magnetico 6 mm ferro, 5 mm ottone
- passo polare 11 mm
- forza polare verticale 115 N/cm<sup>2</sup>
- spessore minimo consigliato 2 mm
- spessore max prestazioni 5 mm
- diametro pezzo minimo 4 cm<sup>2</sup> (2x2 cm)

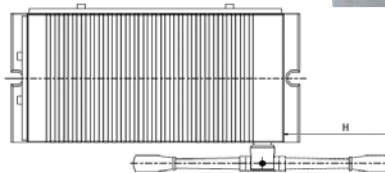
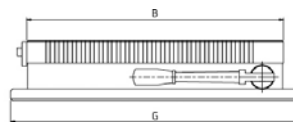
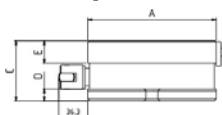

Codice	€	A (mm)	B (mm)	C (mm)	D (mm)	E (mm)	G (mm)	H (mm)
C607050120	---	120	180	75	15	27	220	135
C607050121	---	120	220	75	15	27	260	135
C607050140	---	140	260	75	15	27	300	132
C607050150	---	150	300	75	15	27	340	152
C607050155	---	160	320	75	15	27	360	172

Codice	€	A (mm)	B (mm)	C (mm)	D (mm)	E (mm)	G (mm)	H (mm)
C607050160	---	160	360	75	15	27	400	172
C607050190	---	200	400	84	19	27	440	200
C607050200	---	200	500	84	19	27	540	200
C607050250	---	200	600	84	19	27	640	200
C607050300	---	300	600	84	19	27	640	165

MAGNETI



### Piano magnetico a fittissima polarità

Piano magnetico al neodimio a fittissima polarità.

**Caratteristiche:**

- polo magnetico 1,5 mm ferro, 0,8 mm ottone
- forza polare verticale 80 N/cm<sup>2</sup>
- spessore minimo consigliato 1,5 mm
- spessore max prestazioni 5 mm
- diametro pezzo minimo 4 cm<sup>2</sup> (2x2 cm)

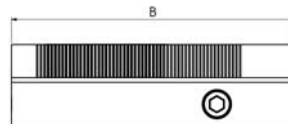
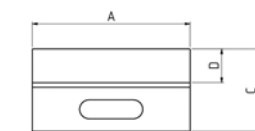

Codice	€	A (mm)	B (mm)	C (mm)	D (mm)
C607100005	---	100	180	52	22
C607100010	---	130	250	60	22
C607100012	---	150	250	60	22
C607100015	---	150	300	60	22
C607100020	---	150	350	60	22

Codice	€	A (mm)	B (mm)	C (mm)	D (mm)
C607100025	---	150	450	60	22
C607100030	---	200	320	60	22
C607100040	---	200	400	60	22
C607100070	---	300	500	60	22
C607100075	---	300	600	60	22



### Piano magnetico a fittissima polarità

Piano magnetico al neodimio a fittissima polarità, spessore ridotto del piano.

**Caratteristiche:**

- polo magnetico 1,5 mm ferro, 0,8 mm ottone
- forza polare verticale 80 N/cm<sup>2</sup>
- spessore minimo consigliato 1,5 mm
- spessore max prestazioni 5 mm
- diametro pezzo minimo 4 cm<sup>2</sup> (2x2 cm)

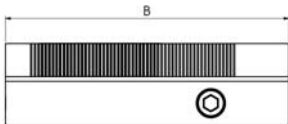
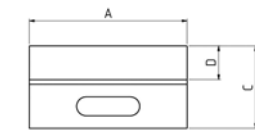

Codice	€	A (mm)	B (mm)	C (mm)	D (mm)
C607150130	---	130	250	38	20
C607150150	---	150	300	38	20

Codice	€	A (mm)	B (mm)	C (mm)	D (mm)
C607150200	---	200	400	38	20